

# HSE ROHS

REV	ECN NO	DESCRIPTION	DATE	NAME
A		NEW		

## Specifications

- 1.Current Rating:3.0Amps
- 2.Insulation Resistance:1000 MΩ min.
- 3.Dielectric withstanding Voltage:1000V AC/DC
- 4.Contact Resistance:20 mΩ max.
- 5.Operating Temperature:−40°C to+105°C
- 6.Contact Material: Brass
- 7.Insulation Material:Asfollows,UL94V−0,Black
- 8.Plated: Au Over Ni

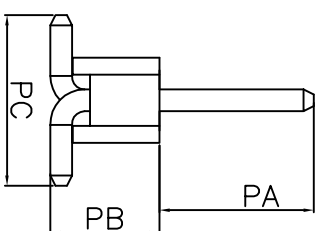
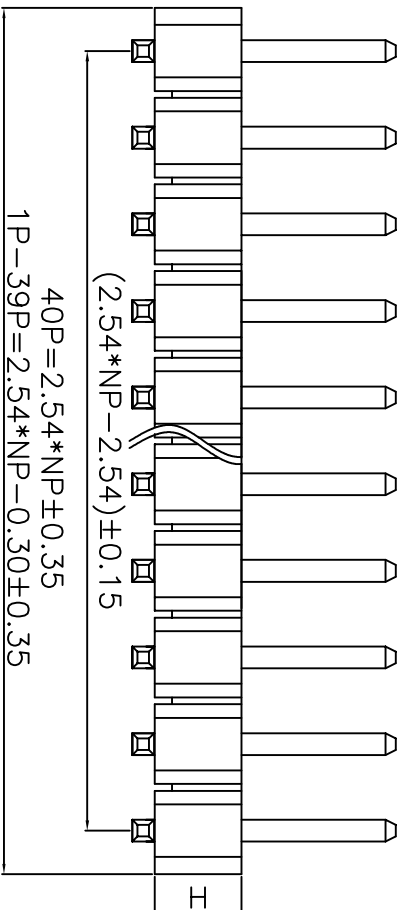
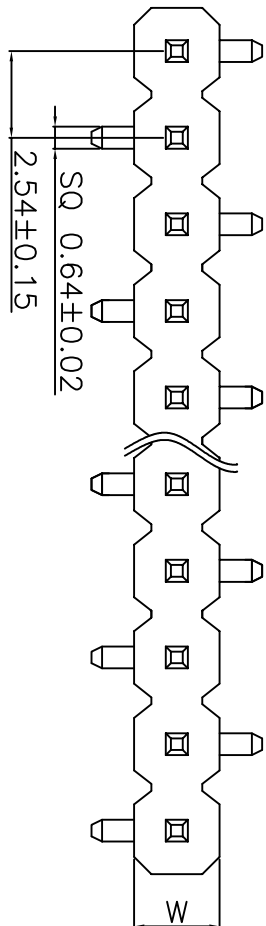

## Ordering Information

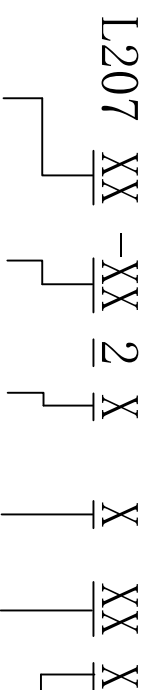

Insulation Height*Width (H*W)	NO. of Pins Per Row:	Insulation Material	Contact Plating	Serial NO.	Packing
Option:	1-50P	1-BPT	0=0.8" Gold	01-69	A=PE Bag
10=1.0*2.0		2=PPS	1=Au1" Gold		B=Tube
15=1.5*2.3		3=NW6T	2=Au1.5" Gold		C=Tray
25=2.54*2.5		4=LCP	3=Au2" Gold		D=Reel
		5=VW66	4=Au3" Gold		
		6=Customized	5=Au5" Gold		
		7=NV46	6=Customized		
		8=VY9T	7=Gold/Tin		
			8=1in		

## Dimension antitheses list

ITEM	PC	PB	PA	H	Pin Length
Standard	5.00	3.20	4.50	2.54	10.40
Alternate					

## LDCONN 东莞连大精密制品有限公司

DongGuan LianDa Precision Products Co., LTD

STANDARD TOLERANCE (EXCEPT SPECIFIED)	LINEAR	ANGLES
.0 ±0.30	0.°	±3°
.00 ±0.20	.0°	±2°
.000 ±0.10	.00°	±1°

TITLE	PH2.54mm Pin Header Single Row SMT	DRAWN BY	YTT	16.02.03
PART NO	L20725-XX2XXXXX	CHECKED BY		
DRAWING NO		APPROVED BY		
SCALE	1:1	UNITE	mm	PAGE
				1/1
				SIZE
				A4

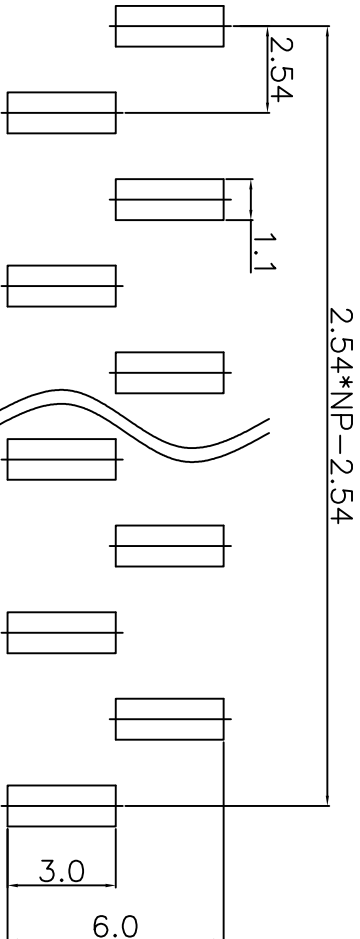

PCB LAYOUT