

HSF RoHS

REV	ECN NO	DESCRIPTION	DATE	NAME
A	—	NEW	5/29-'20	HYJ

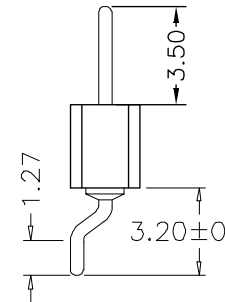

2.54±0.15

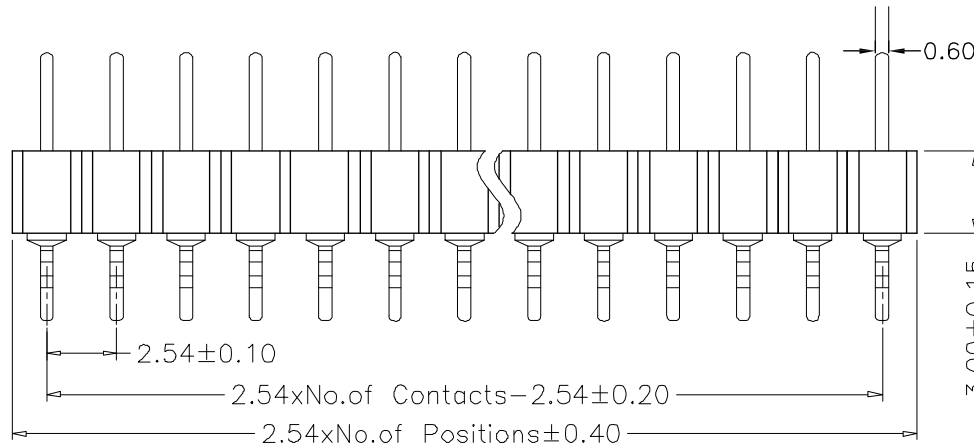

Technical Data

Material:

Pin(outer sleeve): Brass,machined CuZn38Pb2

Plating(outer sleeve):

Tin plated: 2μm/80μ"Ni, 5μm/200μ"Sn

Gold Plated: 2μm/80μ"Ni, Full gold

Insulator(black): Glass filled thermoplastic polyester
UL94V-0

Electrical:

Current rating: 3Amps/contact max.

Contact resistance: £4mW/contact

Insulation resistance: ³ 1000MWat V=100V

Operating voltage: 60VAC/DC

Mechanical:

Operating temperatures: Gold Plated: -55°C to +125°C

Tin plated: -40°C to +105°C

Ordering Information

L487XX - X X XX A

P数
XX=XXP

包装类型
A=袋装

流水号
01-99

产品类型
9=特殊

电镀规格
7=内金外锡

STANDARD TOLERANCE (EXCEPT SPECIFIED)

LINER	ANGLES
.0 ±0.30	0.° ±3°
.00 ±0.20	.0° ±2°
.000 ±0.10	.00° ±1°

LDCONN 连大		东莞连大精密制品有限公司 DongGuan LianDa Precision Products Co., LTD			
TITLE	排针圆孔型-J PH2.54X3.0 1XNP 卧贴 PA3.5 PC3.2	DRAWN BY	HRJ	6/17-'20	
PART NO	L487XX-97XXX	CHECKED BY			
DRAWING NO		APPROVED BY			
SCALE	1:1	UNIT	mm	PAGE	1/1
				SIZE	A4